



Premium Building Products  
That Protect

## 1. Product Name

Jiffy Seal Waterproofing Membranes

- Jiffy Seal 140/60
- Jiffy Seal 140/60 CW (Cold Weather)
- Jiffy Seal 140/60 AK (Alaska)
- Jiffy Seal 400
- Jiffy Seal 500

### Primers

- Jiffy Seal No. 100 Primer
- Jiffy Seal No. 100 VOC Primer
- Jiffy Seal No. 80 Primer
- Jiffy Seal No. 80 VOC Primer
- Jiffy Seal No. 80 Green Concrete Primer
- Jiffy Seal No. 6000 Water-Based Primer
- Jiffy Seal No. JS160H Mastic

## 2. Manufacturer

Protecto Wrap Co.  
1955 South Cherokee St.  
Denver, CO 80223  
(800) 759-9727  
(303) 777-3001  
Fax: (303) 777-9273  
E-mail: info@protectowrap.com  
www.protectowrap.com

## 3. Product Description

### BASIC USE

The Jiffy Seal waterproofing membrane system is designed for use on concrete, masonry, metal and wood structures as positive protection against water, salts and certain acids and alkalis. Areas of application include foundation walls, split slabs, tunnels, plaza decks, parking decks, balconies, spandrels, earth shelters, bridge decks, planters, shower pans, beneath stucco and in mechanical rooms.

- Jiffy Seal 140/60 is recommended for application at air and surface temperatures of 40 degrees F (4 degrees C) or above
- Jiffy Seal 140/60 CW is recommended for application at temperatures from 25 - 75 degrees F (-4 degrees - 24 degrees C). When temperatures fall below 40 degrees F (4 degrees C), overlaps must be lightly primed
- Jiffy Seal 140/60 AK can be applied at temperatures as low as 25 degrees F (-4 degrees C) without priming overlap areas. For these types of cold temperature installations, the mem-

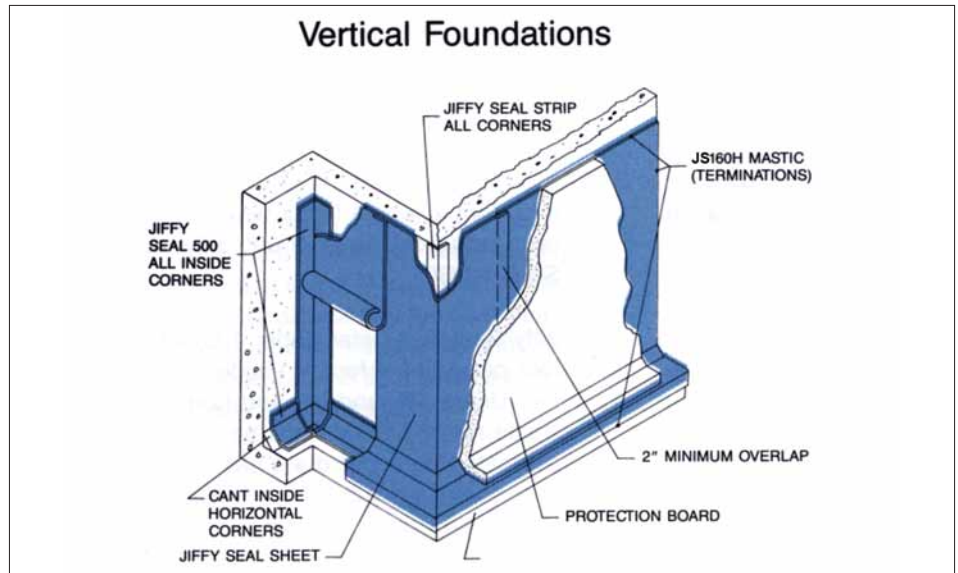

Vertical foundation application details

branes must be stored in a heated area above 60 degrees F (16 degrees C) for a minimum of 2 hours prior to application. Remove only the material that can be readily installed within 1 hour. When temperatures range between 25 and 40 degrees F (-4 and 4 degrees C), any material left in the cold for more than an hour must be primed at overlaps

- Jiffy Seal 400 is a 70 mil (1.8 mm) heavy duty waterproofing membrane for application on bridge decks and parking structures where extra strength may be required. Asphaltic concrete can be applied directly against the membrane for a positive bond immediately after the protective polyethylene film has been removed. Jiffy Seal is not intended as a wearing surface and must be covered after application
- Jiffy Seal 500 is a 60 mil (1.5 mm) unreinforced conformable sheet used for detailing around protrusions, drains, footings and uniform surfaces

### BENEFITS

- Jiffy Seal is environmentally safe and meets NIOSH/OSHA manufacturers standards and regulations
- Jiffy Seal is reinforced and provides superior puncture resistance and strength over other sheet membranes
- Jiffy Seal membranes are inert, inorganic and will never rot, decay or be affected by bacteria/fungus
- According to service needs, either Jiffy Seal

140/60, Jiffy Seal CW, Jiffy Seal AK or Jiffy Seal 400 may be used

- When properly applied, Jiffy Seal systems provide protection for the life of the structure
- Jiffy Seal requires no curing period. It can be applied over a wide temperature range and then can be immediately overlaid or backfilled
- Jiffy Seal gives the design professional the advantage of a strong reinforced waterproofing membrane that can be applied down to 25 degrees F (-4 degrees C)
- A unique "Zip Strip" in the polyethylene release film along both edges of the roll provides both a built-in overlap seam guide and a self-adhering overlap, eliminating the need for a joint seal tape or compound process
- There is no paper backing to remove during installation
- Jiffy Seal products are totally cold-applied over a wide temperature range
- Molecular bonding of seams forms Jiffy Seal into a monolithic membrane over or around the entire surface being waterproofed
- Protecto Wrap's high-quality control guarantees a uniform thickness over the entire project

### PACKAGING

See Tables 1 and 2.

### COMPOSITION & MATERIALS

Jiffy Seal preformed membranes are manufactured from a formulation of premium

grade bituminous resins modified with synthetic resins. This SBS modified, rubberized asphalt is then reinforced with a strong, inert reinforcement to withstand puncture and severe stress. The reinforcement is sandwiched between 2 layers of rubberized asphalt, making the membrane tacky on both sides, which means the membrane bonds cleanly to the primed surface and to itself on overlap areas. A release film is laid on the top of the membrane to keep the material from adhering to itself prior to application.

**COMPATIBILITY**

Jiffy Seal is compatible with asphalts and most urethanes. If there are any questions about product compatibility, contact a Protecto Wrap representative before applying Jiffy Seal in such applications.

**ACCESSORY MATERIALS**

JS160H Mastic and Protecto Wrap primers are specially formulated for use with Jiffy Seal membranes. A good drainage design at or near the footings, along with a drainage mat, will ensure a sound waterproof system.

No. 100 Primer is a high-tack SBS rubber base primer. It is used on all vertical surfaces before application of the membrane and on all surfaces with temperatures between 25 and 40 degrees F (-4 and 4 degrees C).

No. 100 VOC Primer is a VOC compliant version of Protecto Wrap's standard No. 100 Primer.

No. 80 Primer is an asphalt based primer suitable for use on all horizontal applications above 40 degrees F (-7 degrees C).

No. 80 VOC Primer is a VOC compliant version of Protecto Wrap's standard No. 80 Primer.

No. 80 Green Concrete Primer is for use on green concrete surfaces.

No. JS160H Mastic is a rubberized blend of bituminous and synthetic resins used for sealing detail cuts and membrane terminations.

No. 6000 Water-Based Primer is a water-based primer that contains no VOCs. The No. 6000 Primer comes in a 1 gallon concentrate. Mix the concentrate at a ratio of 1 part water to 1 part concentrate for a vertical application (or as needed for jobsite conditions). For horizontal applications, mix 2 parts water to 1 part concentrate.

**LIMITATIONS**

- Jiffy Seal is not recommended for application where the membrane will be exposed to continuous sunlight
- Do not apply primer or membrane to wet,

**TABLE 1 PRODUCT PACKAGING (JIFFY SEAL)**

	Jiffy Seal 140/60	Jiffy Seal 400	Jiffy Seal 500
Length, ft (m)	50 (15.2)	50 (15.2)	50 (15.2)
Width, in (mm) <sup>1</sup>	12, 30 (305, 762)	30, 60 (762, 1524)	6, 12 (152, 305)
Rolls/carton	4, 1, 1	1	8, 4
Weight/carton, lb (kg)	60, 84 (27, 38)	68, 138 (31, 63)	75 (34)
Coverage, ft <sup>2</sup> (m <sup>2</sup> )	50, 125 (4.6, 11.6)	125, 250 (11.6, 23)	25, 50 (2.3, 4.6)

<sup>1</sup> Special widths are available upon request.

**TABLE 2 PRODUCT PACKAGING (PRIMER AND MASTIC)**

	No. 100 Primer	No. 80 Primer	JS160H Mastic
36 10.5 oz tubes, lb (kg)	-	-	41 (18.6)
1 gallon can, lb (kg)	38 (17.2)	38 (17.2)	55 (25)
5 gallon pail, lb (kg)	46 (21)	46 (21)	68 (31)
55 gallon drum, lb (kg)	485 (220)	485 (220)	-

**TABLE 3 TYPICAL PHYSICAL PROPERTIES (JIFFY SEAL)**

	Jiffy Seal 140/60	Jiffy Seal 400	Jiffy Seal 500
Thickness, mil ± (mm)	60 (1.5)	70 (1.8)	60 (1.5)
Tensile strength, membrane	425	425	-
Tensile strength of polyester reinforcement only (ASTM D412), psi (kPa) min	3200	3200	-
Elongation (ASTM D412), %	500	500	1500
Permeance (ASTM E96B), max	0.003	0.002	0.003
Puncture resistance (ASTM E154), lb (N)	80 (356)	80 (356)	-
Pliability (ASTM D146)	Passes	Passes	Passes
Tensile strength (ASTM D412), psi (MPa)	600 (4.1) min	500 (3.5) min	-
Color	Black	Black	Black
Water absorption	0.23	0.23	0.23
Exposure to fungi in soil for 16 weeks (GSA-PBS 07115)	Unaffected	Unaffected	Unaffected
Resistance to hydrostatic head (feet of water) <sup>1</sup>	150	150	150

<sup>1</sup> Hydrostatic head tests are performed by applying membrane on primed concrete, then sealing the waterproofed concrete to a pressure chamber. Water is introduced to 150 head feet.

- damp, frosty or contaminated surfaces
- Do not apply primer or membrane to frozen concrete
- Jiffy Seal is not recommended as a pond or tank liner except for "between slab" applications
- Do not apply over sealants containing tar. If bitumen modified materials are encountered, consult a Protecto Wrap representative for guidance
- Jiffy Seal is not designed for use as a finished traffic system
- For green concrete, use Jiffy Seal No. 80 Green Concrete Primer
- On rough surface areas, Jiffy Seal must be placed over a well-adhered parget coat

**4. Technical Data**

**APPLICABLE STANDARDS**

**ASTM International**

- ASTM D146 Standard Test Methods for Sampling and Testing Bitumen-Saturated Felts and Woven Fabrics for Roofing and Waterproofing
- ASTM D412 Standard Test Methods for Vulcanized Rubber and Thermoplastic Elastomers-Tension
- ASTM D903 Standard Test Method for Peel or Stripping Strength of Adhesive Bonds
- ASTM D1970 Standard Specification for Self-Adhering Polymer Modified Bituminous Sheet Materials Used as Steep Roofing Underlayment for Ice Dam Protection
- ASTM E96/E96M Standard Test Methods for Water Vapor Transmission of Materials
- ASTM E154 Standard Test Methods for Water Vapor Retarders Used in Contact with Earth Under Concrete Slabs, on Walls, or as Ground Cover

Underwriters Laboratories, Inc. (UL) - UL 790 Standard Test Methods for Fire Tests of Roof Coverings

Department of the Navy - NAVFAC TS-07111

General Services Administration (GSA)

- PBS PCD 07121
- PBS 07115

U.S. Department of Veterans Affairs (VA) - H-08-1

U.S. Army Corps of Engineers (USACE) - CEGS-07111-3-82

Federal Construction Guide Spec - FCGS-07111

American Railway Engineers Association, Chapter 29

**TABLE 4 TYPICAL PHYSICAL PROPERTIES (PRIMER AND MASTIC)**

	No. 100 Primer	No. 80 Primer	JS160H Mastic
Adhesion to steel	Excellent	Excellent	Excellent
Adhesion to concrete	Excellent	Excellent	Excellent
Adhesion to membrane	Excellent	Excellent	Excellent
Shelf life (min)	1 year	1 year	1 year
Tack-free time (minutes)	15 - 45	15 - 45	15 - 45
Coverage ft <sup>2</sup> /gal (m <sup>2</sup> /L)	150 - 200 (3.8 - 5)	175 - 250 (4.4 - 6.3)	22 - 50 (0.6 - 1.3)

Amtrak Standard Specification 7.01

Conforms to California VOC regulations

**APPROVALS**

Consult manufacturer for current information on approvals by code bodies and other industry entities.

**PHYSICAL PROPERTIES**

See Tables 3 and 4.

**5. Installation**

**STORAGE & HANDLING**

Store all material inside in a dry space at temperatures between 50 and 90 degrees F (10 and 32 degrees C). Do not store in direct sunlight. Do not remove material from box until ready to use.

For cold weather applications, store Jiffy Seal in a heated airspace at a temperature of 50 degrees F (10 degrees C) or higher for at least 2 days prior to application. Remove only the material that can be applied within 2 hours.

**PREPARATORY WORK**

Handle and store product according to manufacturer's recommendations.

Deliver materials in manufacturer's original, unopened, undamaged containers with identification labels intact. Store materials protected from exposure to harmful environmental conditions and at temperature and humidity conditions recommended by the manufacturer.

Verify that site conditions are acceptable for installation. Do not proceed with installation until unacceptable conditions are corrected.

**Surface Preparation**

Prior to application, ensure that all surfaces have, at a minimum, a smooth, steel-troweled finish and are clean, free of sharp protrusions, loose aggregate, dust, voids or spalled areas. A broom finish is not permitted.

All exposed metal surfaces must be clean and free of all paint, oil, coatings, rust or any other contaminants. Wire brush and solvent

wipe all metal surfaces.

Repair all areas as needed before applying Protecto Wrap primer.

**CURING**

Concrete must be cured a minimum of 28 days for normal structural concrete and 14 days for lightweight structural concrete.

Remove all forms as soon as possible to prevent moisture entrapment. Grind uneven form lines flush to the wall. Fill all tie holes.

Do not apply Jiffy Seal over frozen substrates. For green concrete application, use Jiffy Seal No. 80 Green Concrete Primer. Consult Protecto Wrap Co. for green concrete cure time recommendations.

Use form release agents that will not transfer to the concrete or block walls. Concrete curing compounds must be resin based and contain no oil, wax or pigment. If Jiffy Seal membranes are to be applied to a concrete or wood surface where other curing compounds or wood treatment is to be used, contact Protecto Wrap for recommendations.

If additives have been placed in the concrete that could slow the dissipation of moisture, contact Protecto Wrap Co. before installation of Jiffy Seal.

Masonry walls must not have struck joints. Make sure all masonry joints on block and brick walls are struck flush in order to provide a smooth surface. On rough or porous surfaces, use a well-adhered mortar coat to provide a smooth surface.

**Corners**

For all inside horizontal corners, use cant strips or fillets and Jiffy Seal 500. Wood or fiber cant strips are not recommended.

After application of primer and Jiffy Seal 500, terminate the membrane a minimum of 3" (76 mm) beyond the detail tape. The Jiffy Seal must be applied flush to all angles of the inside corner. If the design does not allow for a cant strip at interior corners, consult Protecto Wrap

Co. for detail recommendations.

All outside corners must be double-covered to a minimum of 6" (152 mm) on each side of the axis of the corners. Apply a 12" (305 mm) wide strip of membrane; then cover it with a full width sheet or overlap the full width a minimum of 6" (152 mm) from the axis on both sides of the corner.

Cant strips of epoxy mortar, latex modified cement mortar or urethane sealants should be used on inside horizontal corners. Do not use JS160H Mastic as a fillet. Ensure outside corners are as smooth as possible and free of sharp protrusions by rounding or chamfering.

Apply JS160H Mastic to all terminations and overlaps within 12" (305 mm) of corners. For inside corners at all vertical-to-horizontal transitions, apply a troweled bead of JS160H Mastic to the overlap. Trowel the mastic 3" (76 mm) up and 3" (76 mm) out from the transition on the seam. A 60 mil (1.5 mm) maximum wet film thickness is recommended. Apply mastic the same day of application.

**Protrusions and Drains**

Areas around pipe, conduit or any protrusions through the membrane should be taped with a 6" (152 mm) piece of Jiffy Seal 500. Jiffy Seal 500 should be forced and formed to fit tightly to the protrusion and the deck.

At the drain opening, apply a light coat of primer and allow it to fully cure. Cover the drain at least 6" (152 mm) past all perimeters with Jiffy Seal 500. Remove the release film, make an X cut and form the Jiffy Seal 500 into the drain, ensuring that the membrane has 100% contact with the primed metal drain surface.

Double-ply the opening with a full sheet of Jiffy Seal 140/60 over the Jiffy Seal 500. Cut and form it around or into the protrusion or drain. This should be followed with a troweled bead of JS160H Mastic. Special care should be taken in placing a troweled bead of JS160H Mastic at any drain, conduit or protrusion where cutting or forming of the membrane is required.

JS160H Mastic and Protecto Wrap primers are specifically formulated for use with Jiffy Seal membranes. Substitutions are specifically not recommended.

A good drainage design at or near the footings, along with a drainage mat, will assist in having a waterproof system. Protecto Wrap 2000V and 2000H drainage boards are recommended and approved for use with the Jiffy Seal waterproofing system.

**Expansion Joints and Cracks**

For joints less than 1/4" wide (6.4 mm) with movement less than 25%, use a 12" (305 mm) strip of Jiffy Seal 140/60 to cover the opening.

All joints 1/4" (6.4 mm) and wider, or those that move 25% or more, must be treated as a standard expansion joint. Follow the approved sealant manufacturer's recommendation for design and use of appropriate sealing materials.

Place a 12" (305 mm) strip of Jiffy Seal 140/60 face down over the expansion area, leaving the release film in place to create a slip plane over the joint. Cover the entire deck with standard width Jiffy Seal 140/60. Apply the material from the low point of the slope to the high point in a shingling effect. Remove the release film and place protection board immediately after application of the membrane.

**APPLICATION**

**Priming**

The application surface must be cleaned using a broom, vacuum or an air compressor dispensing clean, dry air so that all dust, loose concrete, etc., is removed.

Thinning of the primer is not recommended. When not in use, seal open containers to prevent evaporation of the solvents.

Apply primer to all surfaces by roller or brush, at a rate of 150 - 250 ft<sup>2</sup>/gal (3.8 - 6.3 m<sup>2</sup>/L), depending on the porosity of the surface. Primed surface must be free of runs, puddles or excessive primer, as the presence of these conditions can result in blistering.

The entire surface to be waterproofed must be primed. Brush or roll out all primer puddles or drips immediately. Prime only as much of the surface as can be covered with the membrane in half a working day. Do not cover wet primer. The primed surface must be protected from dust. Apply membrane when primer is tacky but not wet.

Test the primer using the "Rule of Thumb" method. Press thumb firmly on the primed surface and twist. If the primer feels pliable but does not adhere to thumb, the primed surface is ready for membrane application.

Primed areas not covered within 8 hours must be reprimed. If an area must be reprimed, do not remove existing primer, but be certain the area is clean and dry. The surface must be free of dust, dirt and moisture. Reprime and again allow the primed area to become tacky prior to applying the membrane.

For all vertical applications over 8' (2.4 m) in height, a second coat of primer should be

applied to the top 10" (254 mm) of the surface to be covered. The membrane can be applied when the second coat of primer is tacky but not wet. The top 10" (254 mm) of the membrane, along with all overlaps, must be firmly rolled.

**Vertical Application**

After application of No. 100 Primer, run a strip of Jiffy Seal 500 along the footing joint. Jiffy Seal 500 is unreinforced and may be formed well into the footing corner reaching 3" - 6" (76 - 152 mm) up the vertical wall and 3" - 6" (76 - 152 mm) onto the footing, conforming to any irregularities in the surface.

Remove the release film from Jiffy Seal 500 and apply Jiffy Seal 140/60 from the top edge of the wall downward so that the tack side faces the primed surface. Pull the Jiffy Seal off of the roll to the desired height on the wall or to the height that is going to be readily backfilled.

Set the top edge of the sheet firmly onto the primed surface. Roll or squeegee downward in the center of the material working outward to the edges.

Jiffy Seal must be rolled or squeegeed over the entire membrane surface to gain maximum surface contact to the primed wall. The top 10" (254 mm) edge of the membrane and all overlaps of the membrane must be well-adhered.

Bring Jiffy Seal 140/60 down the wall and onto the footing. Terminate the membrane a minimum of 3" (76 mm) over and past the edge of the footing.

As application proceeds, remove the Zip Strip from the preceding sheet of Jiffy Seal. Move the roll over and align the overlap. Again, pull the membrane off the roll to the desired height and depress the top edge of the material into the primer. Roll or squeegee downward in the center of the material. Working outward to the edges and pay particular attention to the overlap area. Remove the release film from the entire membrane the same day of application and install protection system.

**Mastic Application**

Ensure the release film is removed prior to application of JS160H Mastic. Apply a troweled bead of JS160H Mastic at the top edge of the applied membrane and extend coverage at least 1" (25.4 mm) onto the wall and 1" (25.4 mm) onto the membrane. JS160H Mastic also must be applied at any other termination of the membrane, and this application must take place at the end of the working day or

when application is interrupted by change in construction scheduling.

**Drainage Boards and Footing Drains**

Use Protecto Drain 2000V on vertical walls and Protecto Drain 2000H on horizontal surfaces.

Waterstops, footing drains and most drainage boards are compatible and may be used in conjunction with Jiffy Seal waterproofing membranes. Consult Protecto Wrap for compatible drainage systems.

**Block Walls**

For block wall waterproofing, apply a heavy coat of Jiffy Seal No. 100 Primer and allow it to fully cure. Apply a second coat of primer to the top 10" (254 mm) of the block wall. When the second coat of primer is tacky but not wet, apply Jiffy Seal 140/60. Roll firmly to gain maximum surface contact. Special emphasis should be placed on pressure rolling the top 10" (254 mm) of the membrane along with all seams.

Remove the release film immediately after application of membrane. Place the protection course and backfill immediately after installation of Jiffy Seal. If the membrane will not be backfilled immediately after application, attach mechanical fasteners to the top of the membrane and cover it with a light coat of JS160H Mastic.

**Horizontal Application**

After priming the deck with Jiffy Seal No. 80, apply the Jiffy Seal membrane from the low point to the high point across the fall lines so that the laps shed water on horizontal surfaces. Lay the membrane tack side down on the primed surface. As the liner is applied, smooth it out with a broom or roller to prevent wrinkles, entrapped air and fishmouths, and to ensure maximum contact with the primed surface. Pull the membrane tight and broom or squeegee the material as it comes into contact with the substrate.

Loose-laying the membrane is not recommended. Sixty inch (1524 mm) wide material applicators are available upon request.

As application proceeds, remove the Zip Strip from the preceding sheet of Jiffy Seal. Apply each succeeding sheet in the same manner. Overlap the side laps a minimum of 2" (51 mm).

Pressure rolling the overlaps is essential to the development of a complete and permanent monolithic system. If the membrane is to be exposed for any prolonged amount of time, place protection board over the membrane

the same day of application to reduce the natural outgassing vapor effect of the deck.

Note - Outgassing may be intensified in decks that have been recently subjected to rain, high humidity or other forms of moisture. Consult the Protecto Wrap Company for recommendations if these conditions exist.

At the end of each working day, or when application is interrupted by a change in construction scheduling or adverse weather, apply a troweled bead of JS160H Mastic to all edges of the membrane at terminations. All T-joints, end laps and detail cuts should receive a troweled bead of JS160H mastic the same day of application. Use a troweled bead of JS160H mastic on all end laps the same day of application.

**Wood Decks**

Use exterior grade plywood on all decks requiring waterproofing protection. Fasten decking with ring shank nails. Prior to application, the surface must be clean, free of sharp protrusions, splintering and warping. Panels should be installed with a 1/8" (3.2 mm) gap at butt joints. A 3/4" (19.1 mm) cant strip is required at the wall base prior to the application of Jiffy Seal 500 detail tape. If the design does not allow for a cant, consult Protecto Wrap Company for detail recommendations.

Prime the entire deck with No. 80 Primer and apply Jiffy Seal 140/60 in a shingle fashion from the low point to the high point. Apply the membrane a minimum of 4" (102 mm) up the vertical wall and caulk the termination with JS160H Mastic. If a flashing edge is exposed, cover it with Protecto Wrap Fast Flash, Copper Flash or use a standard counter flash to protect membrane from prolonged sunlight exposure.

**Tile and Pavers**

Jiffy Seal 140/60 is ideal for use as waterproofing substrate under tile, pavers, shower pans and counter tops. Apply Jiffy Seal membrane according to the manufacturer's recommendations for horizontal applications. Remove release film and apply a troweled layer of mortar to the top of the membrane. Be careful not to damage the membrane with the trowel. Do not use a V-notched trowel.

**Repairs**

Carefully inspect the applied membrane before covering to ensure that it is free of large blisters, fishmouths or any damage. If the membrane is damaged and requires repair, clean the affected area and lightly prime at least 6" (152 mm) beyond the area damaged. Cut a Jiffy Seal

membrane patch. Cover the reprimed area, press on the patch and roll firmly. Apply a troweled bead of JS160H Mastic on all edges of the patch. The patch must overlap the damaged area at least 6" (152 mm) on all sides.

**FLOOD TESTING**

Protecto Wrap's warranty cannot be enforced without documentation of a successful leak-free flood test, which must be submitted to the Protecto Wrap Co. within 30 days after testing. The applicator and general contractor must sign the successful flood testing document.

The mastic must cure at least 24 hours prior to flood testing (48 hours prior to flood testing on all planter boxes). Perform a flood test with a minimum of 1" (25.4 mm) and a maximum of 3" (76 mm) of water for 24 hours. Plug all drains and position barriers to contain the water. Repair any leaks prior to covering the membrane. Upon completion of repairs, re-flood the affected area to ensure that repaired leaks are sound.

**PROTECTION**

Jiffy Seal waterproofing systems are not designed for long-term exposure to sunlight and must be protected by a suitable weather resistant system.

To prevent damage to the membrane, apply protection board and backfill as soon as possible following membrane application. Protection board must be suitable to withstand backfill or a topping course.

After removing the separator sheet, place the protection board over the membrane. For vertical applications, place the protection board the same day of application.

Protect non-traffic horizontal surface areas with 90 lb (41 kg) felt. Moderate to heavy traffic areas must be protected with 1/8" (3.2 mm) asphalt hardboard.

Vertical walls must be protected with rigid polystyrene foam, asphalt hardboard or 90 lb (41 kg) felt.

**PRECAUTIONS**

- If other tradespeople are allowed on or near membranes, the contractor must make them aware of the waterproofing. Care should be taken when working around the installation of membranes. Report any consequential damage to contractor for repair
- Protecto Wrap solvent-based primers/mastic are flammable. Avoid exposure to open flames, sparks, etc. Use only in areas with

adequate ventilation. Refer to MSDS for additional information and warnings

## 6. Availability & Cost

### AVAILABILITY

Jiffy Seal is manufactured in Denver, CO, and is available worldwide through a network of Protecto Wrap distributors. For detailed product information or to find a local representative or distributor, contact the Protecto Wrap Co.

### COST

Jiffy Seal waterproofing membranes are competitively priced. Contact a local representative or the corporate office for information.

## 7. Warranty

Protecto Wrap Co. expressly warrants, subject to the Exclusion Of Warranties provision, that its products shall be fit for the ordinary purposes for which such products are intended for a period of 5 years. Contact the manufacturer for complete warranty details.

## 8. Maintenance

None required. If installed in accordance with manufacturer's recommendations, Jiffy Seal should last the life of the structure.

## 9. Technical Services

Complete technical assistance and information are available from Protecto Wrap field representatives and distributors or by contacting the manufacturer.

## 10. Filing Systems

- Reed First Source
- MANU-SPEC®
- Additional product information is available from the manufacturer.