



PROTECTO WALL VP™ INSTALLATION INSTRUCTIONS

GENERAL DESCRIPTION OF PRODUCT AND ACCESSORIES FOR STANDARD INSTALLATION METHOD

- Protecto Wall VP Water Resistive Barrier is a primer-free self-adhering, self-sealing, nonwoven, vapor permeable, microporous polyolefin laminate that provides 98.5% drainage efficiency. No mechanical fasteners are required for the installation. Additional product information is available at www.protectowrap.com.
 - For ease of installation, Protecto Wall VP comes in two widths with split release liner and one flashing tape as noted below:
 - Roll size 40" x 120' = 400 sq ft per roll - (1.2m x 36.58m = 37.16 sq m)
 - Detail Strip (optional) 12" x 120' = 120 sq ft per roll - (0.3048m x 36.58m = 11.15 sq m)
 - Protecto Wrap Accessory Products Required for Standard Installation Method
 - Window & Door Flashing Tape
 - Super Stick® - 4", 6", 9" or 12" x 75' (10.16cm, 15.24cm, 22.86cm or 30.48cm x 22.86m)
 - "Optional" Protecto Wrap Accessory Products for Best Practices
 - Sealant
 - Protecto Sealant 25XL - Refer to Section "K" for approved alternate sealants.
 - Protecto LM Liquid Membrane (paint on option to Protecto Sealant 25XL).
 - Triple Guard Energy Sill Sealer™
 - Installed prior to the perimeter walls to provide a full width gasket under the base. After the perimeter wall and sheathing have been installed, Triple Guard has an integral self-adhering flap for flashing over the face of the sheathing at the base of the wall. Visit www.protectowrap.com for more information.
 - Roll Sizes 3 ½" x 25' or 5 ½" x 25' (8.89cm x 7.62m or 13.97cm x 7.62m)
- Note:** Triple Guard requires the use of a Protecto Wrap Primer for enhanced adhesion to the slab. Refer to Section "J" for Protecto Wrap Primers.

BASIC INSTALLATION PRINCIPLES

- Cover the entire wall area, including gable end walls with Protecto Wall VP in either a horizontal, vertical (or mixed) directional installation.
- For proper water shedding install using shingle-lap fashion (upper layers overlapping lower layers)
- Overlap seams: Minimum of 3" horizontal (head lap) and 6" vertical (side lap)
- Final siding should be in place within 180 days of Protecto Wall VP installation

Notes:

- **Standard Rough Opening Flashing Methods**
 - Information provided in these Installation Instructions covers the Protecto Wrap Standard Rough Opening Flashing Methods and Details for over Protecto Wall VP.
- **Advanced Rough Opening Flashing Methods** (Refer to Appendix "A")
 - For information on applications requiring Flashing of Rough Openings prior to and after window installation, visit www.protectowrap.com for Appendix "A" to Protecto Wall VP Installation Instructions for Protecto Wrap Advanced Rough Opening Flashing Methods and Details of Pre and Post Flashing over Protecto Wall VP.

A. INSTALLATION TEMPERATURE

Product Name	Installation Temperature Range	In-Service Temperature Range
Protecto Wall VP	-20°F (-28°C) to 125°F (51.6°C)	-45°F (-24°C) to 300°F (148.9°C)

B. SUBSTRATE CONDITIONS

Be sure surfaces are ready for product installation in accordance with the following:

- Substrate must be continuous, clean and secure with no gaps in the sheathing.
- Mechanical fasteners used to secure substrate shall be set flush with substrate and secured into solid backing.
- For optimal adhesion, surfaces must be sound, dry to touch, clean and free of oil, grease, dirt, frost and other contaminants.
- The backside of walls where Protecto Wall VP has been installed must not be exposed to rain or standing water conditions.



PROTECTO WALL VP™ INSTALLATION INSTRUCTIONS

C. INSTALLING THE FIRST COURSE

1. Remove only as much Protecto Wall VP from the main roll as you are comfortable installing.
Note: The 40" (1.2m) wide membrane is provided with splits in the release film down the center and 6" (15cm) from each edge to assist with ease of installation.
2. With the roll plumb, start with 6" (15cm) overlapping an outside corner and position with the bottom edge 4" (10cm) below the foundation sill plate, remove just enough release liner (3" to 6" or 8 to 15cm) from the back of the Protecto Wall VP to begin adhering the Protecto Wall VP.

Options

- a. If Triple Guard Energy Sill Sealer is used at base of wall, adhere Protecto Wall VP fully over the upper flap and install flush with the base of the exterior sheathing.
 - b. A 12" (30cm) wide Detail Strip of Protecto Wall VP is available and can be used along the bottom edge of the wall for ease of installation. Install either 4" (10cm) below base of wall or fully covering the upper flap of Triple Guard as noted in (a.) above.
3. Hand press and smooth Protecto Wall VP into place with plastic straight edge. Smooth out any wrinkles and firmly roll into place with a wide hand-pressure roller over the entire area as material is installed to ensure proper adhesion.
 4. Continue to wrap around the perimeter of the structure keeping the bottom edge 4" (10cm) below the sill plate. Once siding is installed, trim Protecto Wall VP as needed.
 5. Unroll Protecto Wall VP across the wall and rough window and door openings, ensuring there are no wrinkles in the material. See Details in paragraphs "F" for trimming of Protecto Wall VP at rough openings for Standard Installation and Appendix "A" for Advanced Installation - visit www.protectowrap.com.
 6. Install Protecto Wall VP in a water-shedding fashion, do not install so as to create reverse laps i.e., the top course is covered by the lower course.
 7. All overlaps must be a minimum of 3" (8cm) on horizontal seams (head lap) and 6" (15cm) on vertical seams (end lap).

D. INSTALLING IN AND AROUND CORNERS

1. For inside corners, install the Protecto Wall VP a minimum of 6" (15cm) on each wall so that it is fully adhered and tight into the corner and is at a sharp 90-degree angle. If it is installed so that it is not tight into the corner, it can be potentially damaged (get cut or ripped) when the cladding is installed.
2. For outside corners, wrap the Protecto Wall VP tightly around the corner and overlap any other course by a minimum 6" (15cm).

Option

Use the 12" (30cm) Detail Strip of Protecto Wall VP at inside and outside vertical corners to allow for ease of installation by overlapping the full sheets 6" (15cm) onto the 12" (30cm) wide strip. Utilize the center split release when installing.

E. INSTALLING SUBSEQUENT COURSES

1. Install subsequent courses in the same manner as the first course. Overlap the course below by at least 3" (8cm) if horizontal and 6" (15cm) if vertical.
2. Ensure that vertical seams are staggered a minimum of 6" (15cm).
3. Terminate top edge of Protecto Wall VP along with any unavoidable reverse laps, during the installation process (or by the end of the workday at the latest). Use Protecto Sealant 25XL to terminate edges. Refer to Section "K" for approved alternate sealants.
4. For gable ends, cover the exposed area and trim off excess material. Use Protecto Sealant 25XL to terminate edges. Refer to Section "K" for approved alternate sealants.
5. Sealant is to be used to terminate all non-shingling edges and detail areas. Sealant to be tooled flat to assure a good seal is achieved with no voids.



PROTECTO WALL VP™ INSTALLATION INSTRUCTIONS

F. WINDOW & DOOR OPENINGS - STANDARD ROUGH OPENING FLASHING METHODS

Remove Protecto Wall VP above header

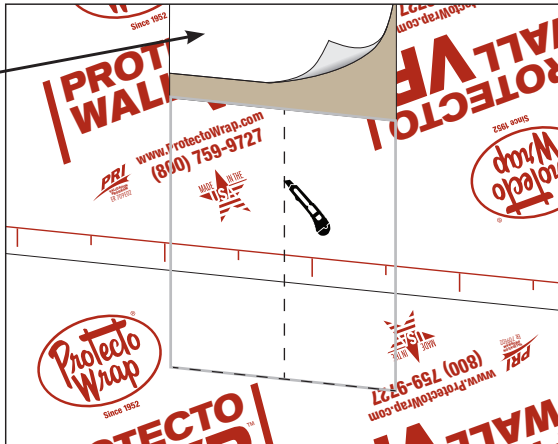

1. Cut the Protecto Wall VP down the center of the opening and along the sill and header of the rough opening. Wrap the Protecto Wall VP back into the rough opening and trim off the excess at the back of the jambs. Cut the Protecto Wall VP above the header in line with the jambs and remove from the sheathing.

Apply additional Protecto Wall VP above header flashing as needed in a shingling overlap fashion

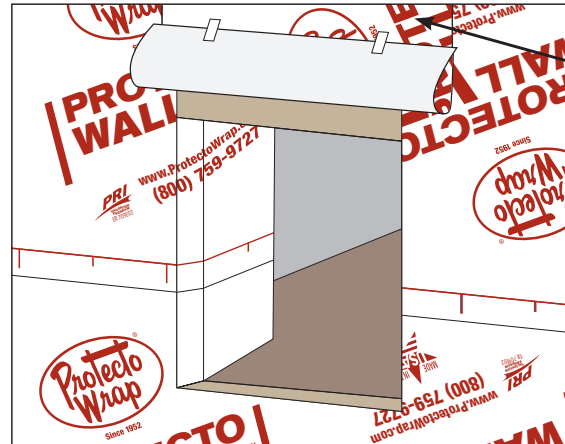

2. Align a piece of 12" wide Detail Strip that is 18" longer than the rough opening width and adhere only the top half to the sheathing. Leave release liner on the bottom half, fold back and temporarily tape up out of the way. Add additional piece(s) of 12" Detail Strip above as needed to a point where it terminates or can be properly overlapped by the row of Protecto Wall VP above.

12" wide Protecto Super Stick Building Tape

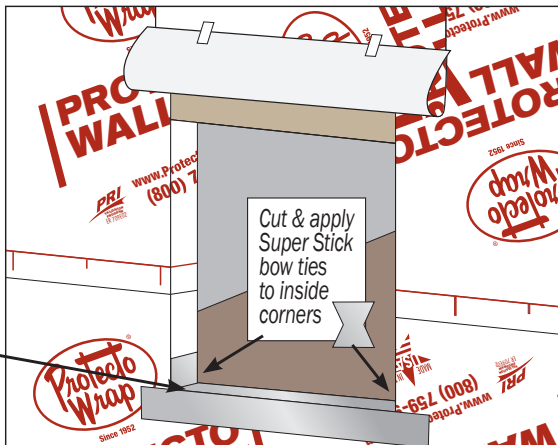

3. Prior to installing the window, flash sill using 12" wide Super Stick Flashing Tape as follows. Step 1 - Cut bow ties from Super Stick and apply to the inside corners. Step 2 - Cut a length of Super Stick 12" longer than the rough opening and adhere over the sill and the Protecto Wall VP as shown a minimum of 3" (8cm).

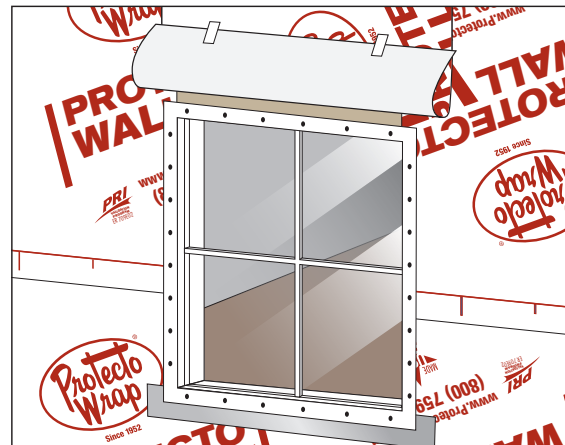

4. Apply Protecto Sealant 25XL to the back side of the window nailing fins at the jambs and header and install the window with fasteners. Remove any excess sealant from beyond the edges of the fins and allow residue to dry before flashing is applied.

Protecto Super Stick Building Tape

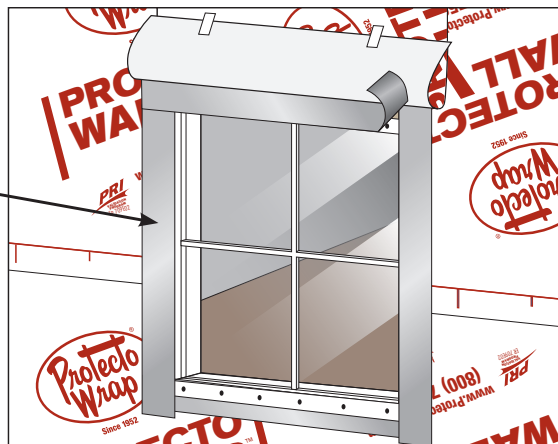

5. Apply Protecto Super Stick Building Tape over nailing fins at jambs first then across the header. Roll into place to ensure good adhesion.

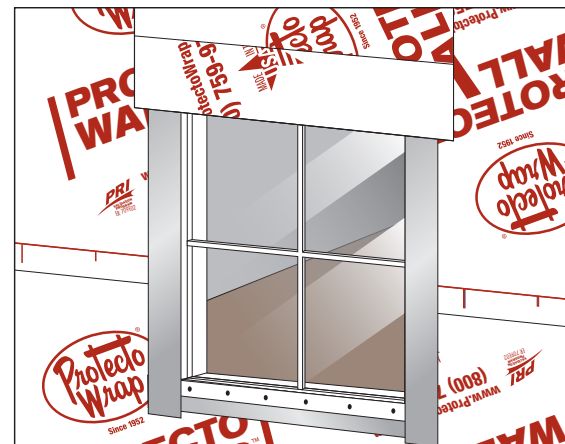

6. After the window has been flashed, un-tape the horizontal piece of Protecto Wall VP above the header, remove the release liner and fold down into position to cover over the header flashing. Roll the Protecto Wall VP into place to assure good adhesion. This completes the Flashing Installation.



PROTECTO WALL VP™ INSTALLATION INSTRUCTIONS

H. SEALING BUILDING ENVELOPE PENETRATIONS

Before installing Protecto Wall VP it is important to seal any penetrations in the building envelope. Protecto Wrap recommends using Protecto Form Flash 1 applied with Protecto Spray Tak Primer. Cut two lengths of Form Flash 1, one to wrap the bottom of the pipe and the other to wrap the top of the pipe. In a water shedding fashion install the first piece from under the pipe come up and around the pipe pressing the tape firmly in place. Once the bottom piece is in place install the top piece so that it overlaps the bottom piece. Use a hand roller to assure good adhesion.



Protecto Form Flash 1 Option
Apply with Protecto Tak Spray Primer.

Options

- Use of **Quick Flash conformable** fitting is an acceptable alternate to Form Flash 1.
- Use of Protecto Sealant 25XL or approved sealant is also an acceptable alternative. Refer to Section "K" for Approved Alternate Sealants.

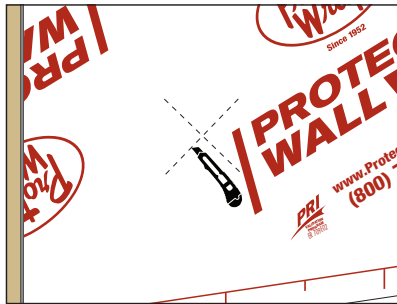

1. When applying Protecto Wall VP over pipe penetrations, cut an "X" in the membrane as shown and slide it over the pipe. The adhesive used on Protecto Wall VP is aggressive so cut the "X" larger than the diameter of the penetration to allow the membrane to slide over the pipe without adhering to it.

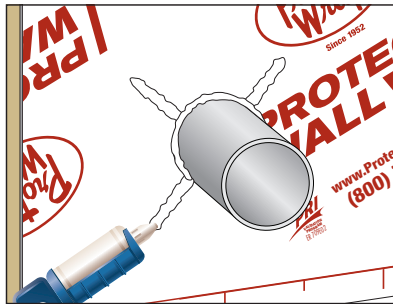

2A. Once the Protecto Wall VP is over the penetration and secured to the sheathing, firmly roll into place and seal the gap and "X" cuts with Protecto Sealant 25XL. Tool sealant firmly into the face of the Protecto Wall VP. See Section "K" for Approved Alternate Sealants.

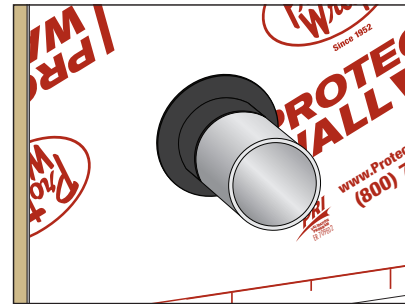

2B. As an Option, apply an outer layer of Form Flash 1 with Protecto Tak Spray Primer similar to that shown above. Note: Form Flash 1 has a 30 day UV Rating.

I. FASTENERS

- Fasteners are not necessary to install Protecto Wall VP. However, if a fastener is used and damages the Protecto Wall VP such that it visibly exposes the substrate or results in the potential for moisture to penetrate thru the damaged area, seal the damaged area with a 6" (15cm) patch of Super Stick or seal the damaged area with Protecto Sealant 25XL. See Section "K" for Approved Alternate Sealants.

J. OPTIONAL ACCESSORIES

- Form Flash 1 – Apply with Protecto Tak Spray Primer
- Available Protecto Wrap Primers for optional accessories:
 - Water Based: Universal Primer
 - Solvent Based: #80 Primer, #100 Primer and BT Primer
 - Spray: Protecto Tak Spray Primer

K. APPROVED ALTERNATE SEALANTS TO PROTECTO SEALANT 25XL

- Dow 758
- Geocel 2300
- Contact Technicalsupport@protectowrap.com (817) 296-7527 to discuss other possible options.

L. STORAGE

- Store Protecto Wall VP rolls in a horizontal position.
- Protecto Wrap VP does not need to be stored in a heated environment.
- Material should be stored indoors in its original and unopened package until needed for use.

M. WARRANTY

- Protecto Wall VP is covered by Protecto Wrap Company's 10 Year Limited Warranty, a copy of which can be found at www.protectowrap.com. Use of accessory products other than the Protecto Wrap approved accessories specifically described in these Installation Instructions will Void the Warranty.

PROTECTO WRAP COMPANY

1955 South Cherokee Street, Denver, CO 80223 · (800) 759-9727 · www.ProtectoWrap.com