



# Protecto **SUPER STICK**

**All Temp/All Weather Building Tape<sup>®</sup>**



**10 Year Limited  
Warranty**

## A GREENER SOLUTION

- No VOCs, HFCs or CFCs
- No off-gassing
- Non-allergenic
- No toxicity

- Protecto Super Stick is a synthetic butyl self adhering membrane
- Install down to -20°F (-28.8°C)
- No primer needed
- 12 month UV exposure
- Split release liner
- Contains no rubberized asphalt
- Can be applied to damp surfaces
- 24 month shelf life
- Safe for use with all vinyl windows
- Self seals around nails and staples
- Thin profile means no need to route window trim boards
- Can withstand temperatures up to 300°F
- IAPMO ER 362 certified
- Meets AAMA 711
- Complies with ASTM E2112 requirements

**HIGH PERFORMANCE FLASHING TAPE WITH SUPER STICK TECHNOLOGY™**



Easy to remove split release liner

# Protecto SUPER STICK All Temp/All Weather Building Tape®

**APPLICATION:**

SURFACES MUST BE CLEAN, FREE OF DIRT, VISIBLE MOISTURE, FROST FREE AND OTHER FOREIGN MATTER. SURFACES MUST ALSO BE TESTED FOR ADHESION.\*

\*Surfaces shall be continuous and smooth without voids, damage or areas that are unsupported. Remove any standing water before beginning installation.

**Figure 1** - Remove half of release liner and adhere to top of rough opening sill. Split release liner allows for integration over weather resistive barrier

**Figure 2** - Install window per manufacturer directions.

**Figure 3** - Apply the vertical side pieces of Protecto Super Stick on top of the window fin. While removing the release paper, roll the tape surface as it comes into contact with the window flange and building face, to assure adhesion and to minimize trapping air beneath the tape.

**Figure 4** - Apply the final top horizontal piece of Protecto Super Stick on the top of the window fin (Fig. 3). Roll all tape surfaces to assure adhesion and smooth out wrinkles and air bubbles.

Precautions: See technical data sheet.

NOTE: For the most current information, refer to the Protecto Wrap website at [www.protectowrap.com](http://www.protectowrap.com).

**AVAILABLE SIZES**

3", 4", 6", 9", 12" x 75'

Flashing Location:	Flashing Lengths and Cut Formulas
Sill Flashing:	Rough opening width + (2X flashing width)
Jamb Flashing:	Rough opening height + (2X flashing width) - 1 inch
Head Flashing:	Rough opening width + (2X flashing width) + 2 inch

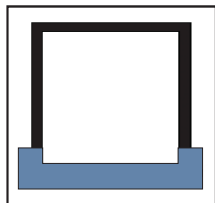

**1** Apply Super Stick into the rough window sill prior to setting the window.

**1A** Alternative method, apply Protecto Sill Pan Flash™.

Leave bottom half of Super Stick release liner on to incorporate on to weather resistive barrier for drain plane.

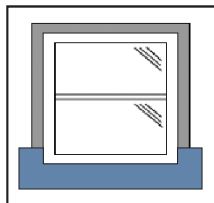

**2** Install window per manufacturer directions.

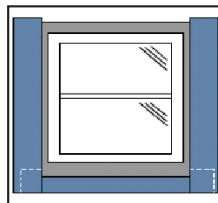

**3** Apply the vertical pieces of Super Stick on top of the window fin.

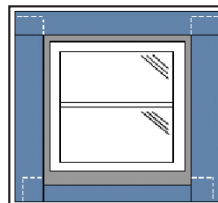

**4** Apply the final top horizontal piece of Super Stick on the top of the window fin.

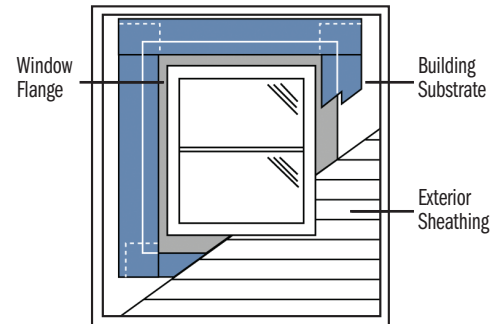

**5** All edges to be shingle lapped to prevent water entry.

## OTHER PRODUCTS UTILIZING SUPER STICK TECHNOLOGY™

### JIFFY SEAL ICE & WATER GUARD EXTREME™

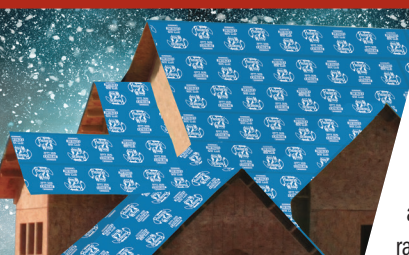

Combines Protecto Wrap's first-in-class skid resistant Jiffy Seal Ice & Water Guard® woven surface film with our Super Stick Adhesive Technology™ which sticks at temperatures as low as -20°F and has an in-service temperature range up to 300°F.

### PROTECTO DECK JOIST TAPE™

A self-adhering, cold-applied tape used as flashing on deck ledger boards and joists to help prevent moisture penetration around properly installed fasteners. Provides a non-corrosive barrier between treated lumber and metal hangers.



### PROTECTO UNIVERSAL PRIMER-FREE MEMBRANE

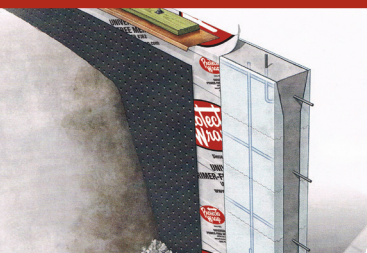

It's specifically designed for use as a thru-wall flashing, below grade waterproofing membrane, seals skirt board foundation to wood frame interface, ICF waterproofing membrane and as an air and vapor barrier.



Protecto Wrap Company  
1955 S. Cherokee Street · Denver, CO 80223  
(800) 759-9727 · [www.ProtectoWrap.com](http://www.ProtectoWrap.com)

